

JCM Fabricated Weld On Line Stop Outlets

Carbon Steel and All Stainless Steel (304 & 316) Construction Available

Outlets, partial sleeves and full sleeves readily available for steel pipe 4" and larger. Size on size and reducing outlets to accommodate folding head or bag stop machinery available. Outlets and partial sleeves available for tank and bulkhead use.

- JCM 440 Type 6 - Full Body- Threaded Plug
- JCM 440 Type 16 - Full Body - Push Plug/Pin
- JCM 440 Type 7 - Outlet Only - Threaded Plug
- JCM 440 Type 17 - Outlet Only - Push Plug/Pin

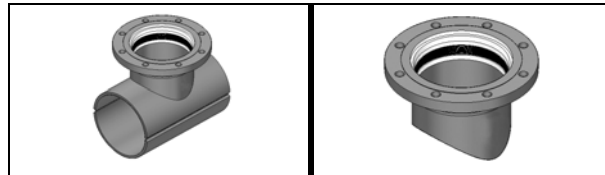

Nominal Pipe Size (IN.)	Sleeve Number	Outlet Sizes	SLEEVE STYLE THREADED PLUG TYPE CODE	SLEEVE STYLE PUSH PLUG/ PIN TYPE CODE	SLEEVE STYLE THREADED PLUG TYPE CODE	SLEEVE STYLE PUSH PLUG/ PIN TYPE CODE
4	440-0450	x 4	T6	T16	T7	T17
6	440-0663	x 4 x 6	T6 T6	T16 T16	T7 T7	T17 T17
8	440-0863	x 6 x 8	T6 T6	T16 T16	T7 T7	T17 T17
10	440-1075	x 8 x 10	T6 T6	T16 T16	T7 T7	T17 T17
12	440-1275	x 8 x 12	T6 T6	T16 T16	T7 T7	T17 T17
14	440-1400	x 12	T6	T16	T7	T17
16	440-1600	x 12	T6	T16	T7	T17
18	440-1800	x 12	T6	T16	T7	T17
20	440-2000	x 12	T6	T16	T7	T17

How To Order:

1. Determine O.D. of pipe
2. Select proper sleeve number
3. Select proper outlet size
4. Select proper sleeve style and outlet plug type code (threaded or push/pin)
5. Add Outlet Type Code (T6 or T16)

Example: For Steel Pipe with 6.63 O.D., full sleeve style, with threaded plug, order: 440-0663 T6

JCM 440 Weld On Line Stop Fitting: test plug/outlet are furnished upon request, contact JCM.

Fittings are fabricated to exact O.D. of pipe.

Larger sizes available.

Other designs offered; contact JCM Industries.

