

# Kinetic Water Ram Repair Parts Kit

Part Number  
**KRRK**

**Remove  
this card for  
instructions!**

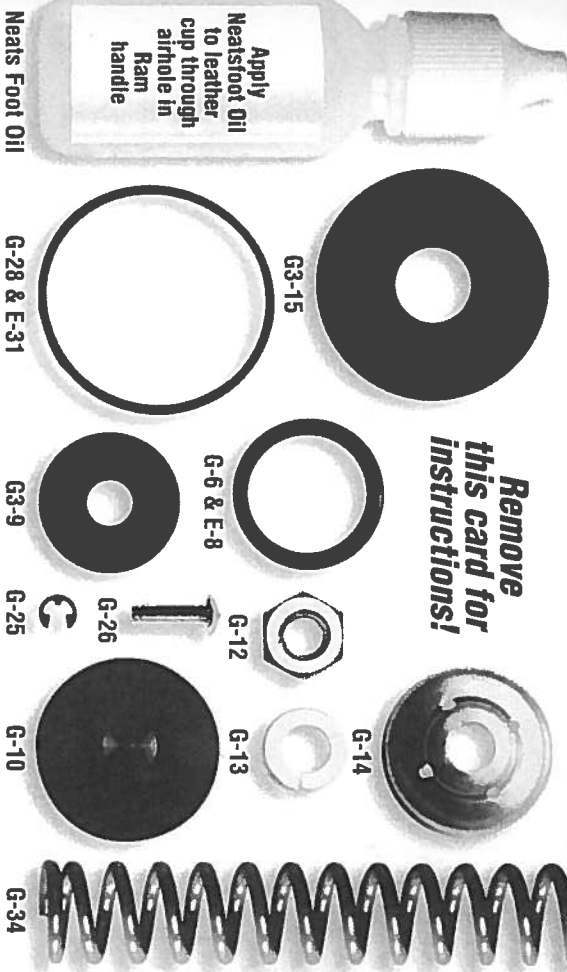

## Kinetic Water Ram Pump Repair Parts Kit

1. Remove G-10 valve seat washer
2. Clean surface of all foreign material. Must be smooth.
3. Replace with new seat washer (G-10)

Item Number	Description
G & E-10	Seat Washer
G & E-12	Nut
G & E-13	Lock Washer
G & E-14	Spreader
G & E-15	Leather Cup

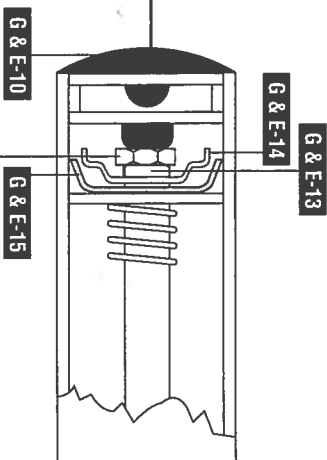

**General** / **General Wire Spring Co.**  
**PIPE CLEANERS**  
 McKees Rocks, PA 15136 USA  
 412-771-6300 Fax: 412-771-2771  
 www.drainbrain.com

# Kinetic Water Ram Parts

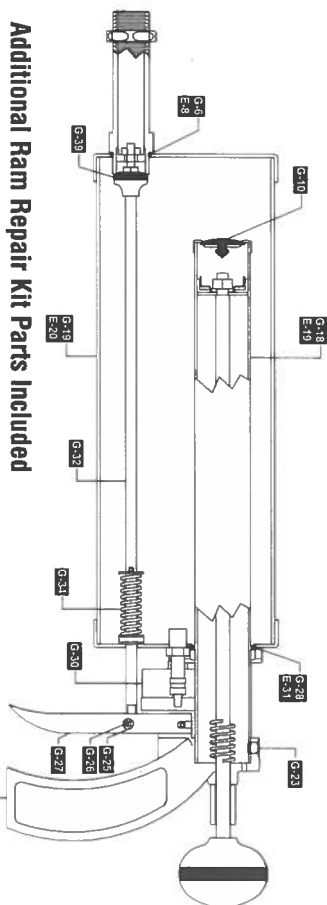

### Additional Ram Repair Kit Parts Included

E-Model Item Number	G-Model Item Number	Description
8	6	O-Ring
25	25	E-Ring
26	26	Trigger Pin
31	28	O-Ring
34	34	Spring
39	39	Seat Washer

For other RAM components,  
see the complete parts list or  
call for additional  
information.

## Repair Instructions

### Pump Assembly Repairs

1. First remove G-25 E-Ring, then G-26 Trigger Pin. "E" MODEL remove additional Trigger Pin and E-Ring.
  2. Loosen G-23 Set Screw in handle assembly.
  3. Lift G-27 Trigger off of G-32 Lifter Rod Connector turning G-20 Handle to right with same movement. Remove Trigger now.
  4. Unscrew and remove G-30 Pressure Gauge.
  5. Unscrew G-20 Handle and remove inner pump assembly. Replace all pump assembly parts shown on back (except G-10) with new parts.
  6. Unscrew and remove G-18 Air Pump Cylinder & Nut (1 3/4") to get at G-10 Valve Seat Washer and G-28 (or E-31, E-MODEL) O-Ring. Replace both now.
- Additional Repairs (optional but recommended)**
7. Unscrew G-5 Locknut until G-1 Shank is removed.
  8. Remove G-32 Lifter Rod Connector and replace G-39 Seat Washer. Replace G-34 Spring now. Reassemble in reverse order.

- Notes:**
- Start rethreading G-1 Shank by hand, then wrench tighten by turning "G-2 Locknut."
  - Finish by tightening down G-5 Locknut to get proper seal.
  - The G-1 shank should extend out from the G-19 Air Chamber Cylinder 3-1/4" (on E-MODEL, 4-3/4").
  - When replacing G-20 Handle, be careful not to cross thread
  - G-15 Leather Cup should be oiled occasionally. Apply oil through air hole in G-20 Handle.
  - Refer to drawing above for location of parts.

C-KRRK-ENG-0412